

### END VIEW / DIMENSIONS

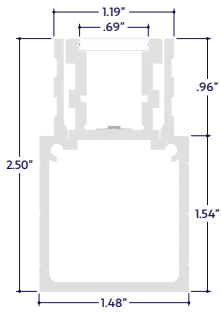

### GENERAL FEATURES

<b>Applications</b>	Ingrade Walk-Over, Accent, Decorative, Recessed Lighting
<b>Lens</b>	Clear, 50% Semi-Frosted, or 100% Frosted
<b>Optics &amp; Asymmetric</b>	15°, 30°, 45°, 60°, 120°, or Asymmetric Optics
<b>Length</b>	Built to Order (+/- 1/8" Tolerance)
<b>Construction</b>	Aluminum Extrusion
<b>Field Cutting</b>	Not Field Cuttable
<b>Weight</b>	0.22 lbs per foot
<b>Mounting</b>	Mounting Channel (8' Segments)
<b>Listing</b>	IP67 Location UL8750, CSA250 UL2108, 67.1.9, 60.4, CSA C22.2 #9
<b>Driver</b>	Remote (Sold Separately)
<b>Temperature Ratings</b>	Operating / Startup: -20° to 48°C (-4° to 120°F) Storage: -40° to 76°C (-40° to 170°F)

### ELECTRICAL

<b>Dimming</b>	0-10V, Forward / Reverse Phase, Lutron, DMX, DALI
<b>Maximum Run (Class 1 Applications)</b>	20' (6W), 30' (4W), 36' (3W, 2W)
<b>Maximum Run (Class 2 Applications)</b>	14' (6W), 21' (4W), 28' (3W), 36' (2W)
<b>Luminaire Voltage</b>	24VDC

### SPECIFY PRODUCT CODE | CHOOSE FROM DROP DOWNS

Series	Lens / Optics	Watts per Foot	Dimming	CCT LED	Listing	Finish	Luminaire Length
<b>A4-ZERA-STN</b>					<b>IP67</b>		
ZERA Standard (A4-ZERA-STN)	Clear Lens (CL)	2 Watts (2W)	0-10V; 100% - 1% (10V)	2400K (24K)	Outdoor IP67*6 (IP67)	Satin / Silver*7 (SA)	Specify Length in Feet & Inches Example: 7'8"
	50% Semi-Frosted Lens (SF)	216 Lumens / ft*1	Phase Dimming: Forward Phase / Reverse Phase (PH)	2700K (27K)		Black (BK)	
	100% Frosted Lens (F)	3 Watts (3W)	Hi-Lume 1% 3 Wire*2 (L3DA)	3000K (30K)			
	Asymmetric Lens (ASM)	324 Lumens / ft*1	Hi-Lume Premier 0.1% JA8*3 (L3D0)	3500K (35K)			
	15° Optics (15D)	4 Watts (4W)	DMX-512*4 (DMX)	4000K (40K)			
	30° Optics (30D)	432 Lumens / ft*1	DALI*5 (DALI)	4500K (45K)			
	45° Optics (45D)	6 Watts (6W)	JA8 0-10V (JA8-10V)	5000K (50K)			
	60° Optics (60D)	648 Lumens / ft*1	Leave Blank for Non-Dimming	5700K (57K)			
				Red (R)			
				Green (G)			
			Blue (B)				
			Amber (A)				

**Note:** Remote drivers wattage sized based on length of run. **Example:** 10' run x 3 Watts per foot = 30 Watts. Driver will be sized to 30 Watts maximum.

- \*1 Lumens per Foot based on 35K CCT LED with Clear Lens (CL). **Example:** 108 Lumens x 2 Watts = 216 Lumens per Foot.
- \*2 (L3DA) 40 watt max Hi-Lume 1% L3DA3W #L3DA4UIUKL-CV240
- \*3 (L3D0) 96 watt max Hi-Lume Premier 0.1% #L3D0-96W24V-U
- \*4 Default DMX address of each fixture is 001. Consult third party DMX commissioner to modify at time of installation.
- \*5 DALI commissioning to be performed by a third party at time of installation. ALUZ does not provide DALI commissioning.
- \*6 Run lengths required for IP67 products. Provide run lengths at time of order.
- \*7 Default finish is Satin / Silver (SA) if left blank.

### LAMP FEATURES

Lamp Type	LEDs
CRI	> 90
Efficacy*	108 Lumens per Watt

Note: Efficacy is based on 35K CCT LED (35K).

### BEAM ANGLES

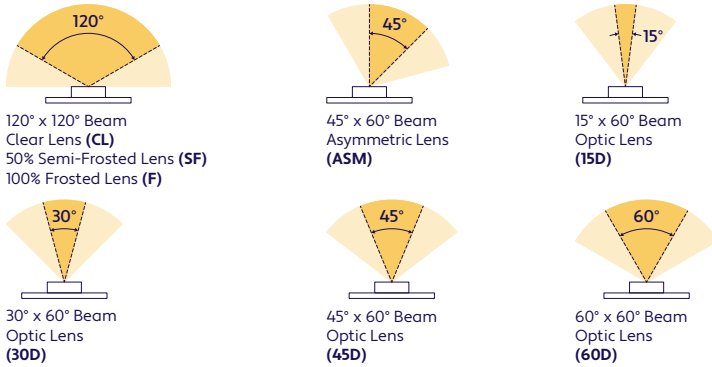

### LENS / OPTICS APPEARANCE

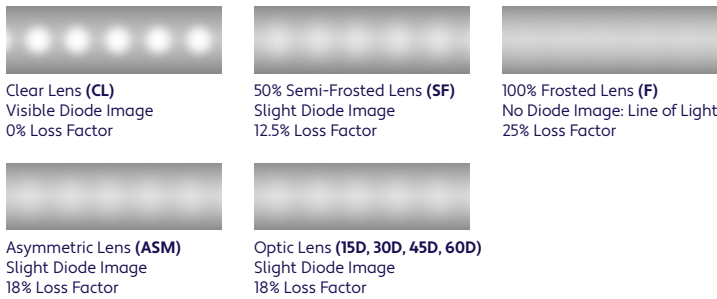

### MOUNTING OPTION

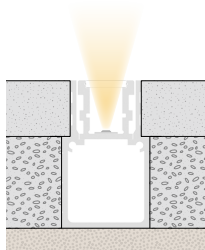

Ingrade / Hardscape

### LAMP SPECIFICATIONS

Lamp Number	Correlated Color Temperature / Description	Efficacy (Lumens per Watt)	L70 LED Life
24K	2400 Kelvin (Incandescent White)	108	
27K	2700 Kelvin (Warm White)	108	
30K	3000 Kelvin (Warm White)	108	
35K	3500 Kelvin (Neutral White)	108	
40K	4000 Kelvin (Neutral White)	108	60,000 hrs.
45K	4500 Kelvin (Neutral White)	108	
50K	5000 Kelvin (Cool White)	108	
57K	5700 Kelvin (Cool White)	108	
R	Red (621nm)		
G	Green (525nm)		
B	Blue (470nm)		40,000 hrs.
A	Amber (590nm)		

To calculate Lumens per Foot, multiply Efficacy by Watts per Foot.  
Example: 108 Lumens per Watt x 2 Watts per Foot = 216 Lumens per Foot.

### SPECTRAL POWER DISTRIBUTION AMBER LED (590nm) TURTLE FRIENDLY

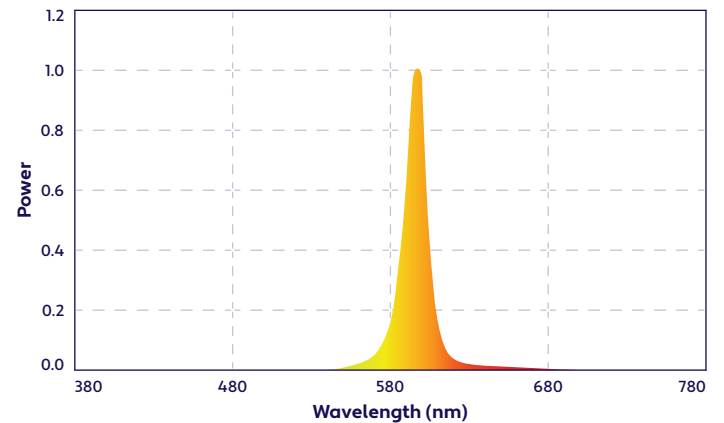

### DRIVERS

Dimming Selection	Product Code	Link to Specification Sheet / URL
Phase Dimming: Forward Phase / Reverse Phase	(PH)	
0-10V: 100% - 1%	(10V)	
Hi-Lume 1% 3 Wire	(L3DA)	
Hi-Lume Premier 0.1% JA8	(L3D0)	
JA8 0-10V	(JA8-10V)	
DMX-512	(DMX)	
DALI	(DALI)	

### MOUNTING ACCESSORIES (Sold Separately)

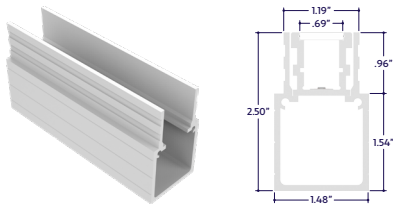

8' Luminaire Housing for Concrete Recess  
(A4-ZERA-STN-LH-X-8')  
X = Specify Finish: Satin (SA) or Black (BK)

Part #	Qty.
A4-ZERA-STN-LH-SA-8'	
A4-ZERA-STN-LH-BK-8'	

**Note:** Available in field cuttable 8' segments.  
Required for concrete recessed applications.  
**Note:** Default Finish is Satin (SA) if unspecified.

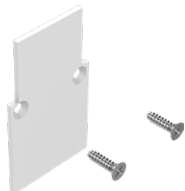

End Cap for Luminaire Housing  
(A4-ZERA-STN-LH-EC-X)  
X = Specify Finish: Satin (SA) or Black (BK)

Part #	Qty.
A4-ZERA-STN-LH-EC-SA	
A4-ZERA-STN-LH-EC-BK	

**Note:** Specify 1 End Cap for each termination.  
**Note:** Default Finish is Satin (SA) if unspecified.



Part #	Lens	Watts per Foot	Dimming	CCT LED	Listing	Finish	Qty.
A4-ZERA-STN-90D					IP67		

**Note:** Specify product code to match specified code from page 1.  
Click on image to see cut sheet for additional details.

### WET CONNECTORS (Sold Separately)

**Note:** Connectors are factory assembled to each run length. Connectors are subject to change without notice.

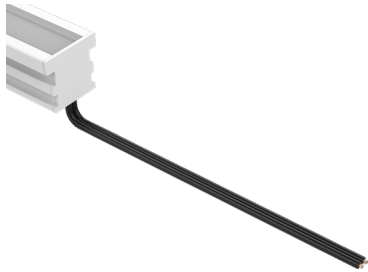

Wet Power Connector  
(A4-ZERA-STN-PC-WET-X)  
X = Specify Length, 36" Default, 25' Maximum

Part #	Length	Qty.
A4-ZERA-STN-PC-WET-	36"	
A4-ZERA-STN-PC-WET-		

**Note:** Specify 1 Power Connector for each lead required.  
Power Connectors are factory assembled to each length.

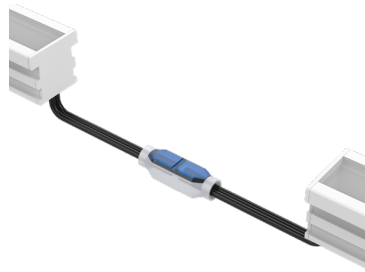

Wet Continuous Connector  
(A4-ZERA-STN-CC-WET-X)  
X = Specify Length, 3" Default

Part #	Length	Qty.
A4-ZERA-STN-CC-WET-	3"	
A4-ZERA-STN-CC-WET-		

**Note:** Specify Continuous Connectors to traverse a gap or obstacle. Continuous Connectors are factory assembled to specified lengths.

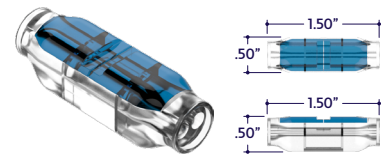

Part #	Qty.
A4-SC-2P-WET	

## DESIGN GUIDELINES

### Individual Fixture

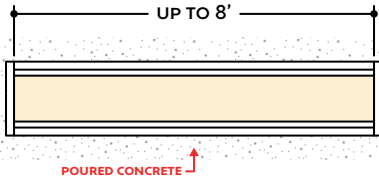

### Continuous Run

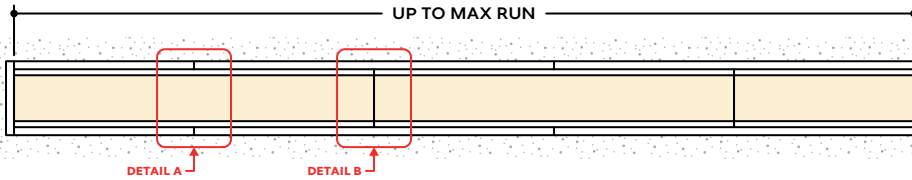

### Run with Mitered Corners

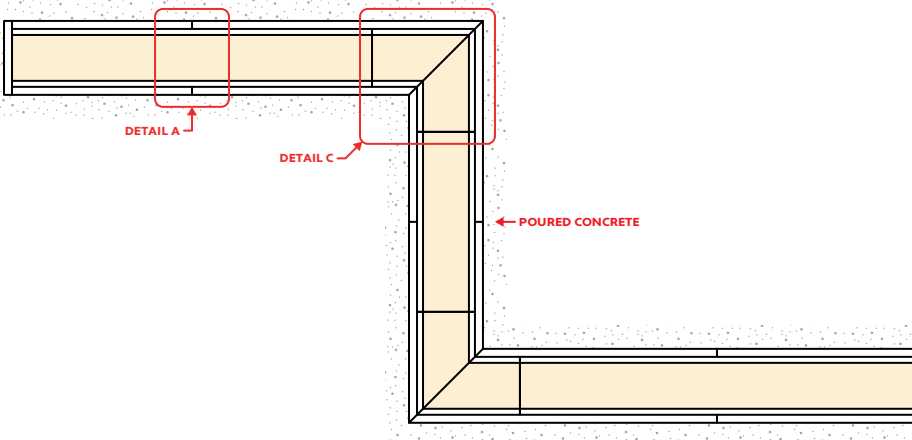

### Runs with Jumper Cable

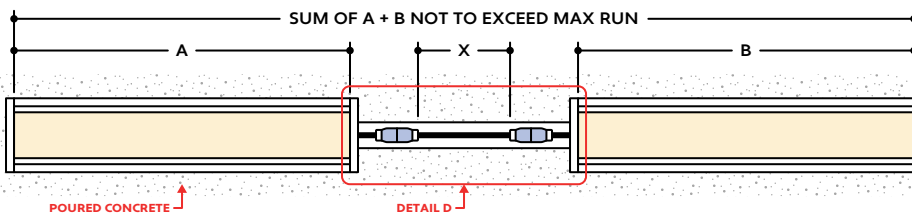

## KEY

- Detail A** **Continuous Connection (Luminaire Housing):** Luminaire Housing holds luminaires in place, field cut and mitered to needed lengths, with segments butted together.
- Detail B** **Continuous Connection (Luminaire Segments):** Luminaire segments are connected using a back-fed splice connection contained within luminaire housing.
- Detail C** **90° Mitered Corner:** Standard 90° Corner. Mitered corners ship assembled and ready to be connected in sequence with a run.
- Detail D** **Jumper Cable:** Used to span a corner or traverse a gap or obstacle in the installation area. Splice connections are made inside Luminaire Housing and connect via conduit (by others).

**Note:** Drawings not to scale. Product may differ from examples shown.